

**COUNTY OF VENTURA
PUBLIC WORKS AGENCY
VENTURA COUNTY WATERSHED PROTECTION DISTRICT**

**ZONE #2
EL RIO RETROFIT FOR
GROUNDWATER RECHARGE**

INDEX TO SHEETS

SHEET NO.	TITLE
1.	GENERAL PLAN
2.	LEMAR AVENUE
3.	WILL AVENUE
4.	SIMON WAY
5.	SALEM AVENUE
6.	HELSAM AVENUE
7.	BALBOA STREET
8.	DETAILS

RECORD DRAWING

DATE PROJECT COMPLETED 3/9/2016
 REVISIONS SUBMITTED BY J. EVERETT
 DRAWING REVISED BY J. TURNER
 APPROVED BY G. DEROSSETT DATE 5/3/16

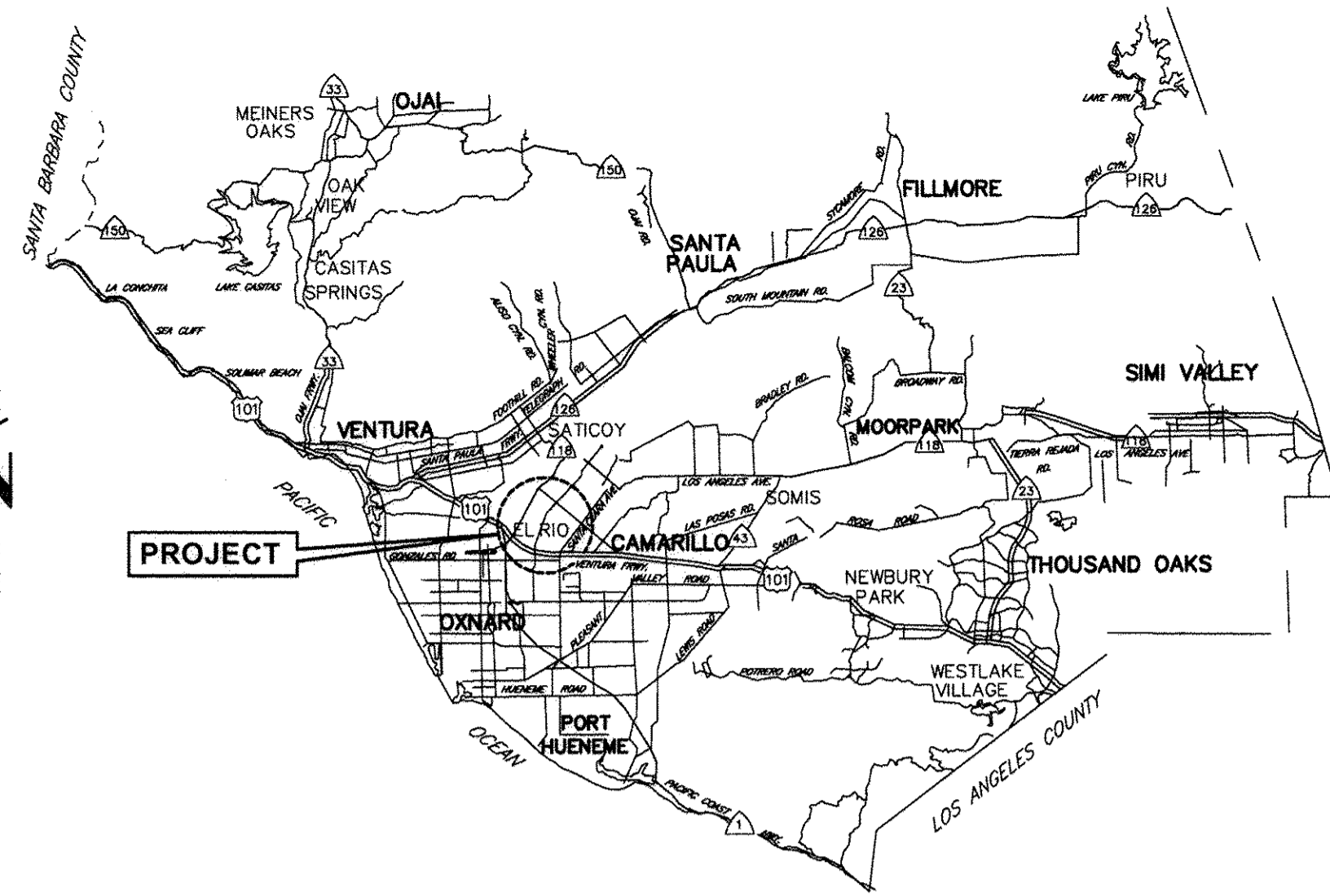

VICINITY MAP

N.T.S.

GENERAL NOTES

- ELEVATIONS SHOWN ARE IN US FEET, NORTH AMERICAN VERTICAL DATUM OF 1988.
- STATIONS SHOWN ON DRAWINGS ARE ALONG CENTERLINE OF STRUCTURE.
- NUMBERS IN \square INDICATE BID ITEMS UNDER WHICH PAYMENT WILL BE MADE.
- LETTERS AND NUMBERS IN \ominus INDICATE THE DETAIL CALL-OUT AND SHEET ON WHICH REFERENCE DETAIL IS SHOWN.
- NUMBERS IN \triangle REFER TO NOTES ON THE SAME SHEET UNLESS OTHERWISE NOTED.
- TOPOGRAPHY AND CROSS SECTIONS FOR THIS PROJECT WERE TAKEN FROM SURVEYS PERFORMED IN 11/2014.
- SOIL TEST BORINGS FOR THE PROJECT WERE MADE IN MAY 2014, AND THEIR LOCATION IS MARKED BY THE SYMBOL \bullet . SUBSURFACE SOIL INVESTIGATION RESULTS ARE FURNISHED FOR INFORMATION ONLY, IN ACCORDANCE WITH SUBSECTION 2-7 OF THE STANDARD SPECIFICATIONS, AND NO WARRANTY IS MADE THEREFOR.
- EXISTING IMPROVEMENTS WITHIN THE RIGHT OF WAY AND WORK AREAS SHALL REMAIN AND SHALL BE PROTECTED UNLESS OTHERWISE NOTED. DAMAGED IMPROVEMENTS SHALL BE REPLACED IN KIND TO A CONDITION EQUAL TO OR BETTER THAN THAT WHICH EXISTED PRIOR TO CONSTRUCTION.
- UTILITIES ARE SHOWN AS KNOWN TO EXIST AT TIME OF SURVEY. UTILITIES MAY HAVE BEEN OMITTED, MISPLACED, AND/OR RELOCATED. CONTRACTOR SHALL EXERCISE CARE IN EXCAVATION AND SHALL PROTECT ALL UTILITIES. EXISTING WATERLINE MAINS ARE APPROXIMATELY 8" TO 18" BELOW FINISHED SURFACE. INDIVIDUAL WATER SERVICES ARE ALSO VERY SHALLOW. EACH RESIDENCE IS SERVED BY WATER, SEWER AND GAS SERVICES. VERIFY ALL LOCATIONS PRIOR TO EXCAVATION.
- SYMBOL \blacktriangle INDICATES THE LOCATION OF THE HORIZONTAL AND VERTICAL CONTROL POINTS WHICH WILL BE FURNISHED BY THE AGENCY FOR THE CONTRACTOR'S USE.

COUNTY OF VENTURA BENCH MARK 111-4 (1986) ELEV.=105.517
 VENTURA COUNTY BRASS DISK 0.5 MILE NORTHERLY ALONG ROSE AVENUE FROM ITS INTERSECTION WITH ORANGE DRIVE, 97.0 FEET WESTERLY FROM THE CENTER OF ROSE AVENUE AT THE ENTRANCE TO THE UNITED WATER CONSERVATION DISTRICT YARD, IN THE CONCRETE FOUNDATION OF A CHAIN LINK FENCE.

POINT #	NORTHING	EASTING	ELEVATION	DESCRIPTION
38	20923.223	19842.705	93.819	MAG NAIL & WASHER
46	20700.304	19672.402	93.445	SCRBX@HELSAM AVE
39	21344.122	20165.595	95.563	SCRBX@PROD WILL AVE
40	21544.261	20331.661	96.665	SCRBX@LEMAR AVE
41	21534.378	20386.002	97.006	SCRBX@LEMAR AVE
42	21492.785	20351.674	96.816	SCRBX@LEMAR AVE
43	20945.117	19887.026	93.950	LT&T VENT.CO.
44	21105.044	19967.166	94.255	LT&T VENT.CO.
45	21284.025	19854.603	94.867	SCRBX@RENE ST

- SEWER ELEVATIONS AND GAS LINE LOCATIONS ARE FROM COUNTY RECORD DRAWINGS DATED 3/10.
- CONTRACTOR SHALL NOTIFY UTILITY OWNERS A MINIMUM OF 48 HOURS PRIOR TO STARTING WORK IN AREAS AFFECTING THEIR FACILITIES.

THE RIO PLAZA WATER COMPANY
 MUTUAL WATER COMPANY OF VINEYARD AVE ESTATES
 SOUTHERN CALIFORNIA EDISON CO.
 SOUTHERN CALIFORNIA GAS CO.
 COUNTY OF VENTURA WATER & SANITATION DISTRICT (SEWER ONLY)
 TIME WARNER CABLE

TEL. NO. (805) 525-4200 FRANK BROMMENSCHENKEL
 TEL. NO. (805) 485-8449 JIM BURKE
 TEL. NO. (714) 796-9932 KIM GURULE
 TEL. NO. (818) 701-4516 P.J. MARTIN
 TEL. NO. (805) 378-3000
 TEL. NO. (818) 700-5910 LISA POWERS

UNDERGROUND SERVICE ALERT

1-800-422-4133
 CALL USA/SC
 FOR UNDERGROUND LOCATION
 2 WORKING DAYS BEFORE YOU DIG

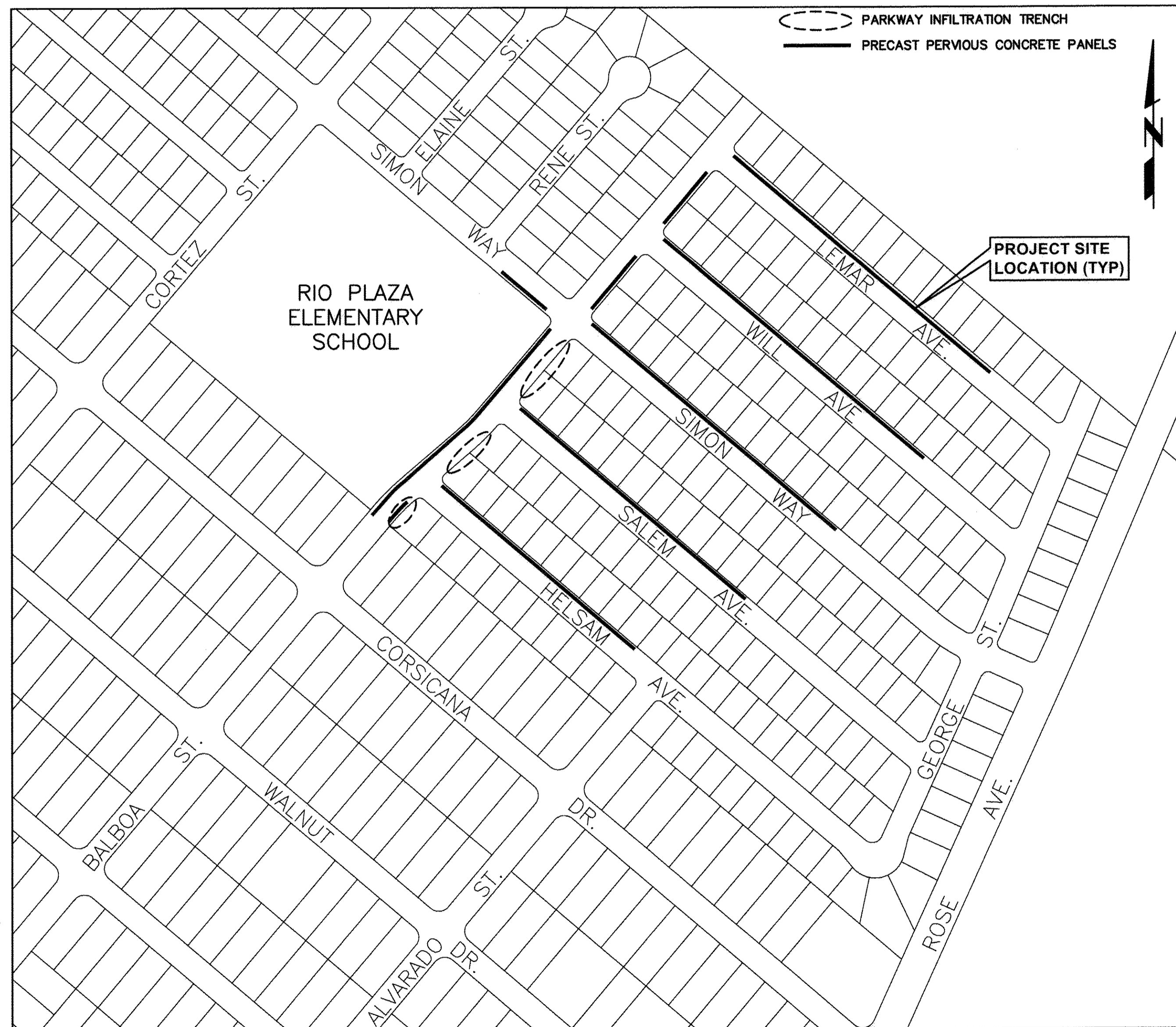

GENERAL PLAN



ABBREVIATIONS

AC	ASPHALTIC CONCRETE
ASTM	AMERICAN SOCIETY FOR TESTING & MATERIALS
CB	CATCH BASIN
CD	CURB DRAIN
CF	CURB FACE
C/L OR CL	CENTERLINE
CO	CLEANOUT
CONC	CONCRETE
CP	CONTROL POINT
CRB	CURB
DH	DRILL HOLE
DIA	DIAMETER
DRWY	DRIVEWAY
ELEV	ELEVATION
EX	EXISTING
FG	FINISH GRADE
FH	FIRE HYDRANT
FL	FLOW LINE
FNC	FENCE
G	GAS
GV	GAS VALVE
INV	INVERT OR FLOW LINE OF PIPE
L	LENGTH
L.F.	LINEAR FEET
MAX	MAXIMUM
MB	MAIL BOX
MIN	MINIMUM
PVC	POLYVINYL CHLORIDE
PP	POWER POLE
PPA	POWER POLE ANCHOR
R	RADIUS
R/W	RIGHT OF WAY
S	SEWER
SD	STORM DRAIN
SDMH	STORM DRAIN MANHOLE
SHT	SHEET
SMH	SEWER MANHOLE
SP	SIGN POST
SPPWC	STANDARD PLANS FOR PUBLIC WORKS CONSTRUCTION
SQ	SQUARE
STD	STANDARD
TC	TOP OF CURB
TOT	TOTAL
TR	TREE
TYP	TYPICAL
V	VERTICAL HEIGHT
W	WATER
WM	WATER METER
WV	WATER VALVE

**INDEX OF STANDARD PLANS
USED BY REFERENCE**

CALTRANS STANDARD PLAN:
 RSP T13 - TRAFFIC CONTROL SYSTEMS FOR LANE CLOSURE ON TWO LANE CONVENTIONAL HIGHWAYS
 SPPWC STANDARD PLANS:
 120-2 CURB AND GUTTER, TYPES A1 & A2
 112-2 CURB AND SIDEWALK JOINTS

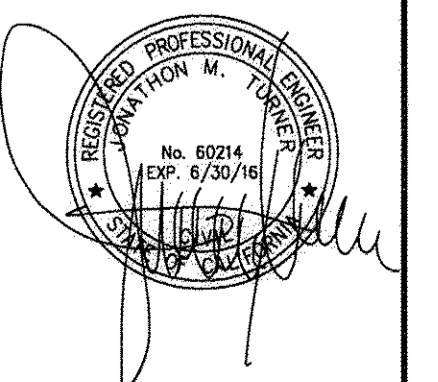

PLOT DATE: 1/2/15 FRED P. PROJECTS: WMPD111401 EL RIO GROUNDWATER RECHARGE CAD PLAN SET (SHT-01.DWG)

REVISION	DESCRIPTION	APP.	DATE
C			
B			
A	ISSUED FOR BID		1-12-15

PREPARED BY:
 PHOENIX CIVIL ENGINEERING, INC.
 4532 TELEPHONE ROAD SUITE 113
 VENTURA, CA 93003
 (805) 658-6800



AGENCY DIRECTOR: *[Signature]* DATE: 1/16/2015
 DISTRICT DIRECTOR: *[Signature]* DATE: 1/15/2015
 PROJECT ENGINEER: *[Signature]* DATE: 1/16/2015

**COUNTY OF VENTURA
PUBLIC WORKS AGENCY
WATERSHED PROTECTION DISTRICT**

SPEC. NO.
WP15-09
PROJ. NO.
40560

**EL RIO RETROFIT FOR
GROUNDWATER RECHARGE
GENERAL PLAN**

SHEET **1**
OF **8**
DRAWING NO.
Y-2-3779

DATE PROJECT COMPLETED 3/9/2016
 REVISIONS SUBMITTED BY J. EVERETT
 DRAWING REVISED BY J. TURNER
 APPROVED BY G. DEROSSETT DATE 5/3/16

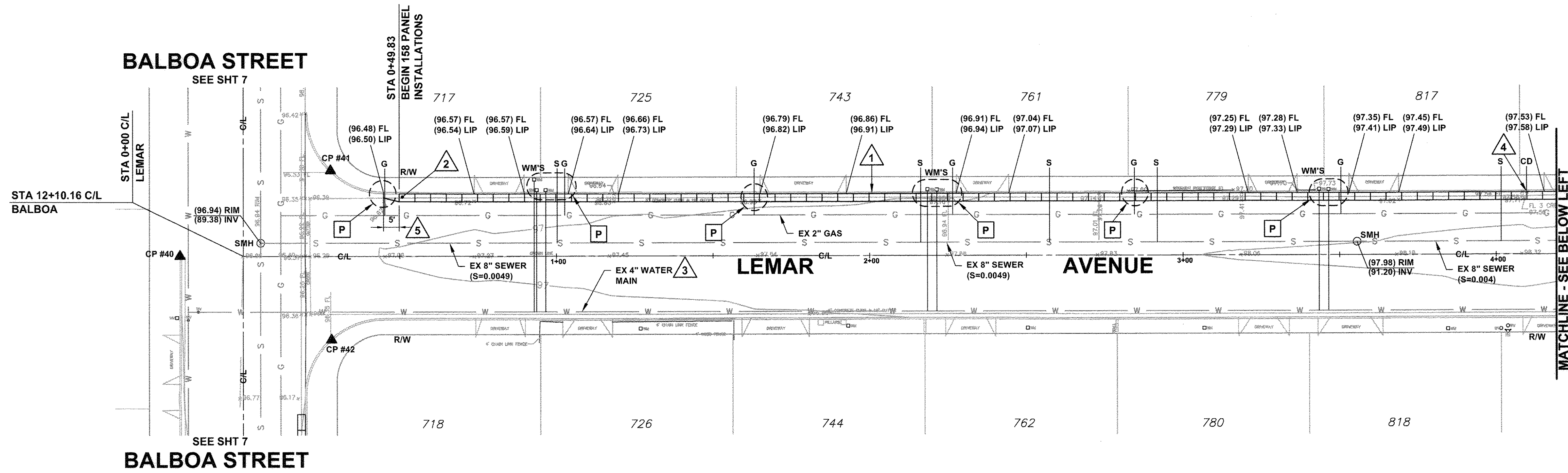

PAGE QUANTITIES
 1 = 158 PANELS
 2 = 1 OBSERVATION WELL
 P = 7
 CONCRETE TRANSITIONS = 2

NOTE: PANEL CROSS SLOPE IS 7% ON THIS SHEET

CONSTRUCTION NOTES

- 1 INSTALL PRECAST PERVIOUS CONCRETE PAVEMENT PANELS. TRANSITION BACK TO EXISTING GUTTER WIDTH LOCATED AT EACH END OF THE PANEL SECTION. SEE 1/8 2/8
- 2 INSTALL OBSERVATION WELL. SEE 1/8
- 3 EXISTING WATERLINE IS 8" - 18" DEEP. SERVICES ARE 2-INCH DIA GALVANIZED PIPE WITH A 1-INCH DIA POLYETHYLENE LINE INSIDE.
- 4 PROTECT IN PLACE OR REPLACE EXISTING CURB DRAIN IF AFFECTED BY PROJECT.
- 5 GUTTER TRANSITION. SEE 1/8

LEGEND

- 12 P POT HOLE REQUIRED
- 999 RESIDENTIAL ADDRESS

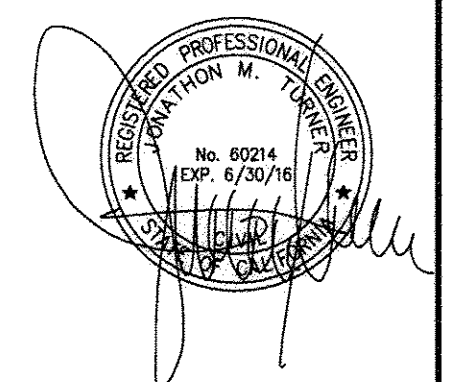
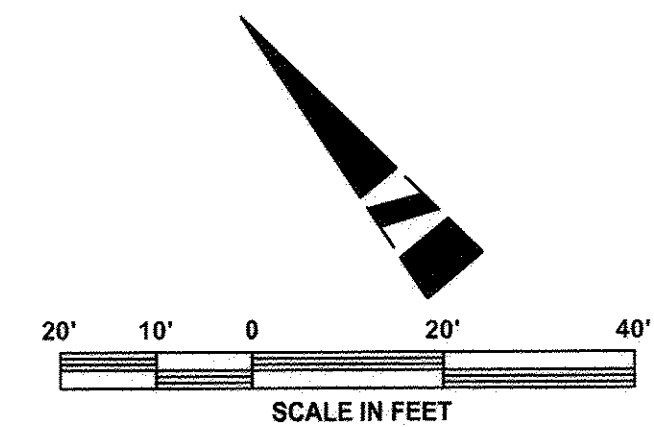
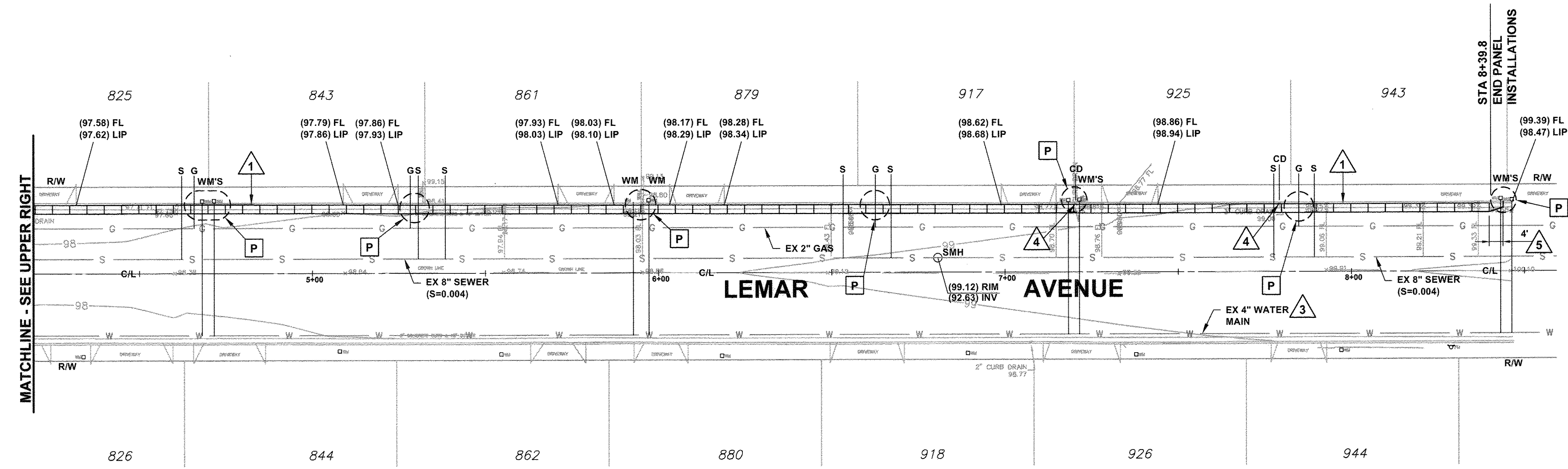

SAVE DATE: 1/2/15 FRED P:\PROJECTS\WMPD\11401_EL_RIO_GROUNDWATER_RECHARGE\CAD\PLANS\SET_SHT-02.DWG

D			
C			
B			
A	ISSUED FOR BID	1-12-15	
	REVISION	DESCRIPTION	APP. DATE

PREPARED BY:
PHOENIX CIVIL ENGINEERING, INC.
 4532 TELEPHONE ROAD SUITE 113
 VENTURA, CA 93003
 (805) 658-6800

JT	DESIGNED	<i>[Signature]</i>	1/14/15
AR	DRAWN	<i>[Signature]</i>	1/16/2015
GD	CHECKED	<i>[Signature]</i>	1/15/2015

**COUNTY OF VENTURA
 PUBLIC WORKS AGENCY
 WATERSHED PROTECTION DISTRICT**

SPEC. NO.
WP15-09
 PROJ. NO.
40560

**EL RIO RETROFIT FOR
 GROUNDWATER RECHARGE
 LEMAR AVENUE**

SHEET **2**
 OF **8**
 DRAWING NO.
Y-2-3780

DATE PROJECT COMPLETED 3/9/2016
 REVISIONS SUBMITTED BY J. EVERETT
 DRAWING REVISED BY J. TURNER
 APPROVED BY G. DEROSSETT DATE 5/3/16

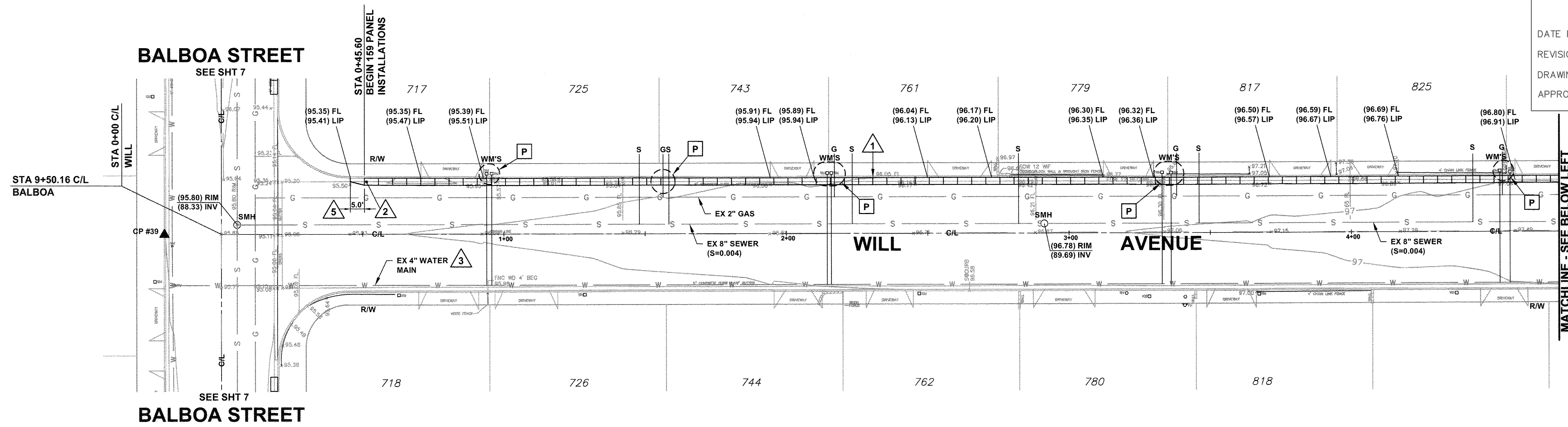

NOTE: PANEL CROSS SLOPE IS 6.5% ON THIS SHEET

PAGE QUANTITIES

- ① = 159 PANELS
- ② = 1 OBSERVATION WELL
- P = 7
- CONCRETE TRANSITIONS = 2

CONSTRUCTION NOTES

- ① INSTALL PRECAST PERVIOUS CONCRETE PAVEMENT PANELS. TRANSITION BACK TO EXISTING GUTTER WIDTH LOCATED AT EACH END OF THE PANEL SECTION. SEE ① ②
- ② INSTALL OBSERVATION WELL. SEE ① ⑧
- ③ EXISTING WATERLINE IS 8" - 18" DEEP. SERVICES ARE 2-INCH DIA GALVANIZED PIPE WITH A 1-INCH DIA POLYETHYLENE LINE INSIDE.
- ④ PROTECT IN PLACE OR REPLACE EXISTING CURB DRAIN IF AFFECTED BY PROJECT.
- ⑤ GUTTER TRANSITION. SEE ① ⑧

LEGEND

- ⑫ P POTHOLE REQUIRED
- 999 RESIDENTIAL ADDRESS

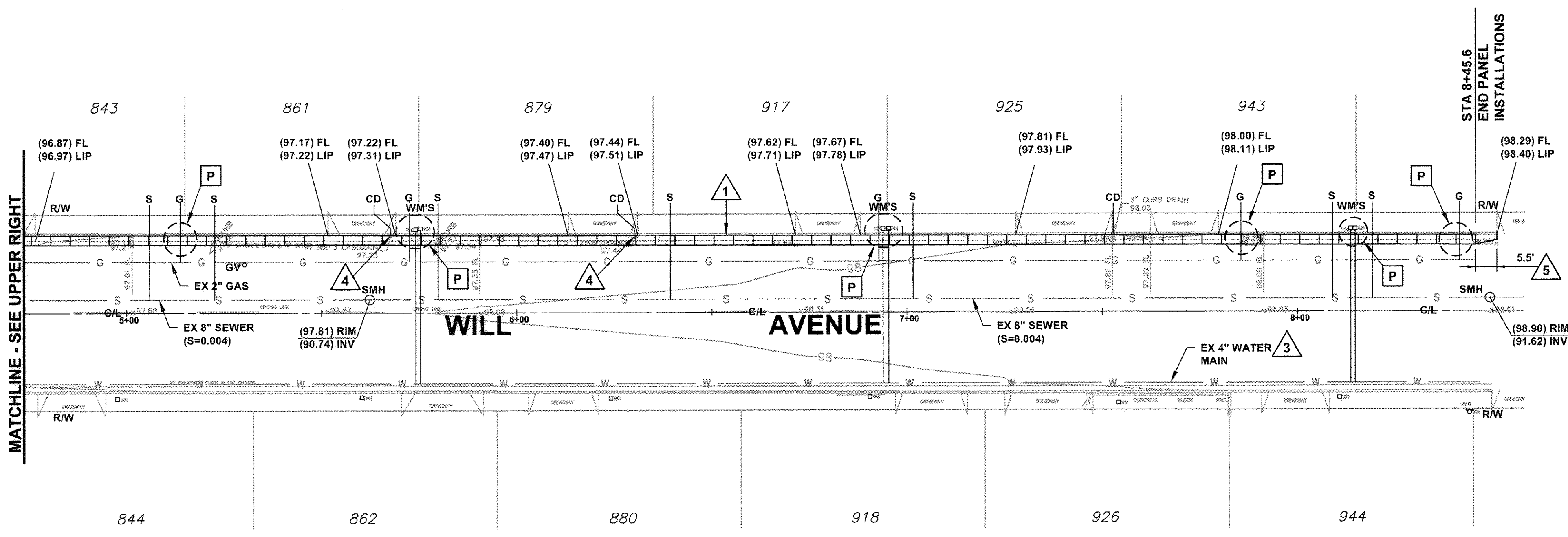

SAVE DATE: 1/2/15 FRED P:\PROJECTS\MPD11101.EL RIO GROUNDWATER RECHARGE\CAV\PLANS\SH7-03.DWG

D			
C			
B			
A	ISSUED FOR BID	1-12-15	
Δ	REVISION	DESCRIPTION	APP. DATE

PREPARED BY:
PHOENIX CIVIL ENGINEERING, INC.
 4532 TELEPHONE ROAD SUITE 113
 VENTURA, CA 93003
 (805) 658-6800

DESIGNED	JT	1/14/15
DRAWN	AR	1/16/2015
CHECKED	GD	1/15/2015

**COUNTY OF VENTURA
 PUBLIC WORKS AGENCY
 WATERSHED PROTECTION DISTRICT**

SPEC. NO.
WP15-09
 PROJ. NO.
40560

**EL RIO RETROFIT FOR
 GROUNDWATER RECHARGE
 WILL AVENUE**

SHEET **3**
 OF **8**
 DRAWING NO.
Y-2-3781

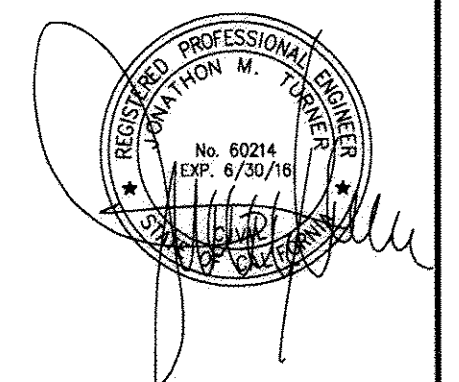

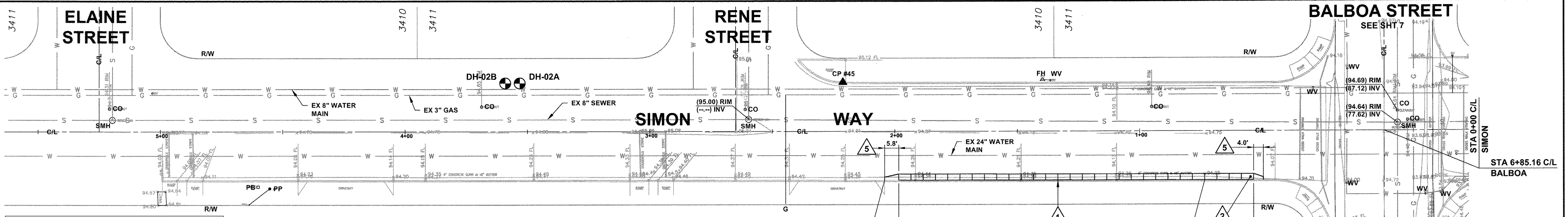

RECORD DRAWING
 DATE PROJECT COMPLETED 3/9/2016
 REVISIONS SUBMITTED BY J. EVERETT
 DRAWING REVISED BY J. TURNER
 APPROVED BY G. DEROSSETT DATE 5/3/16

RIO PLAZA ELEMENTARY SCHOOL
 600 SIMON WAY

NOTE: PANEL CROSS SLOPE IS 7% ON THIS SECTION

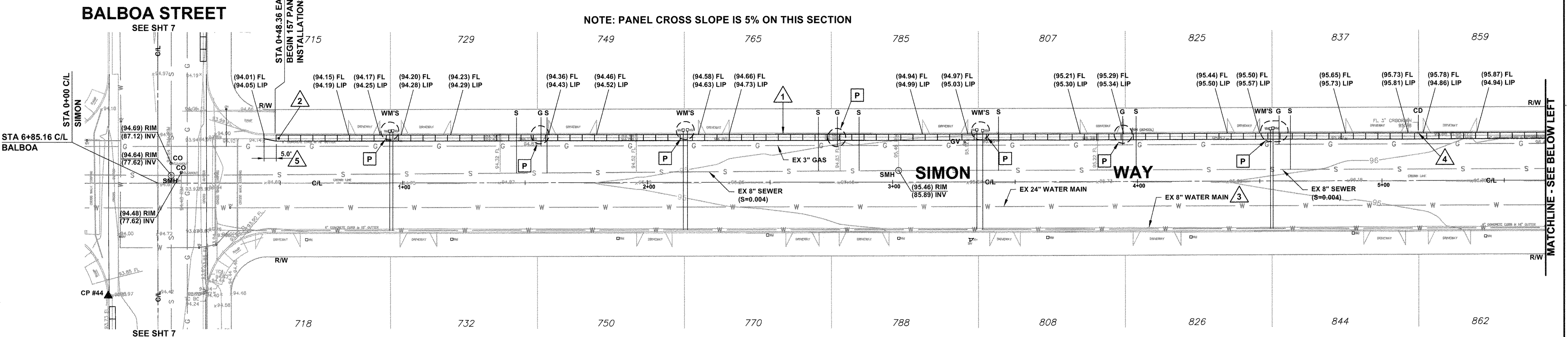

NOTE: PANEL CROSS SLOPE IS 5% ON THIS SECTION

NOTE: PANEL CROSS SLOPE IS 5% ON THIS SECTION

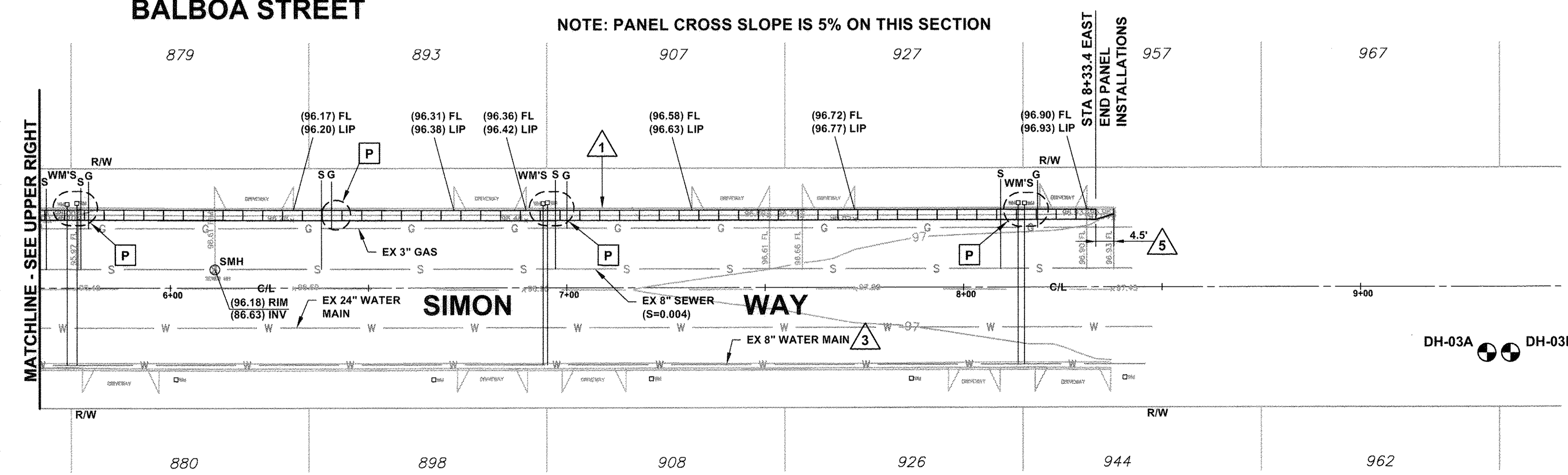

CONSTRUCTION NOTES

- 1 INSTALL PRECAST PERVIOUS CONCRETE PAVEMENT PANELS. TRANSITION BACK TO EXISTING GUTTER WIDTH LOCATED AT EACH END OF THE PANEL SECTION. SEE
- 2 INSTALL OBSERVATION WELL. SEE
- 3 EXISTING WATERLINE IS 8" - 18" DEEP. SERVICES ARE 2-INCH DIA GALVANIZED PIPE WITH A 1-INCH DIA POLYETHYLENE LINE INSIDE.
- 4 PROTECT IN PLACE OR REPLACE EXISTING CURB DRAIN IF AFFECTED BY PROJECT.
- 5 GUTTER TRANSITION. SEE

PAGE QUANTITIES

- 1 = 185 PANELS
- 2 = 2 OBSERVATION WELL
- P = 7
- CONCRETE TRANSITIONS = 4

LEGEND

- P POTHOLE REQUIRED
- 999 RESIDENTIAL ADDRESS
- APPROXIMATE DRILL HOLE/PERCOLATION TEST LOCATION

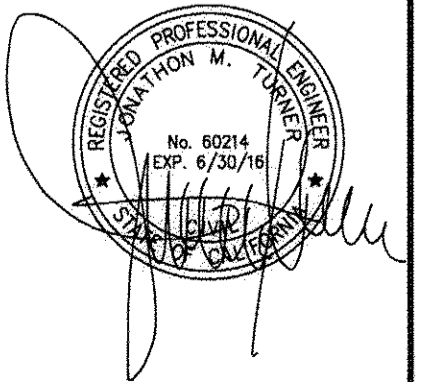
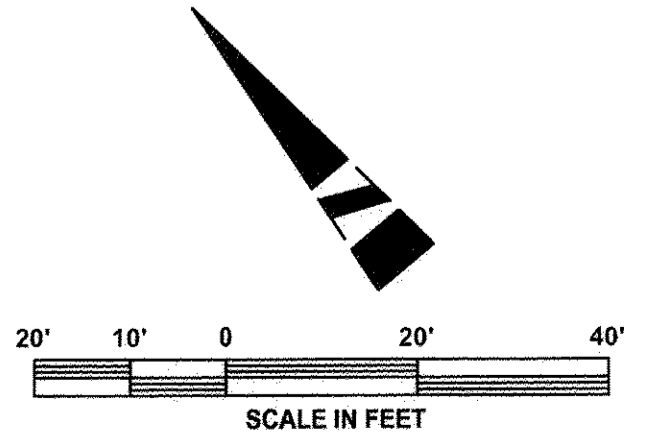

D	ISSUED FOR BID	1-12-15
C		
B		
A		
Δ	REVISION DESCRIPTION	APP. DATE

PREPARED BY:
PHOENIX CIVIL ENGINEERING, INC.
 4532 TELEPHONE ROAD SUITE 113
 VENTURA, CA 93003
 (805) 658-6800

JT DESIGNED
 AR DRAWN
 GD CHECKED

PROJECT MANAGER: *[Signature]* 1/15
 DISTRICT DIRECTOR: *[Signature]* 1/15/2015

**COUNTY OF VENTURA
 PUBLIC WORKS AGENCY
 WATERSHED PROTECTION DISTRICT**

SPEC. NO.
WP15-09
 PROJ. NO.
40560

**EL RIO RETROFIT FOR
 GROUNDWATER RECHARGE
 SIMON WAY**

SHEET **4**
 OF **8**
 DRAWING NO.
Y-2-3782

SAVE DATE: 1/22/15 FRED P:\PROJECTS\WMPD11401 EL RIO GROUNDWATER RECHARGE\CADD\PLANETS\SH7-04.DWG

DATE PROJECT COMPLETED 3/9/2016
 REVISIONS SUBMITTED BY J. EVERETT
 DRAWING REVISED BY J. TURNER
 APPROVED BY G. DEROSSETT DATE 5/3/16

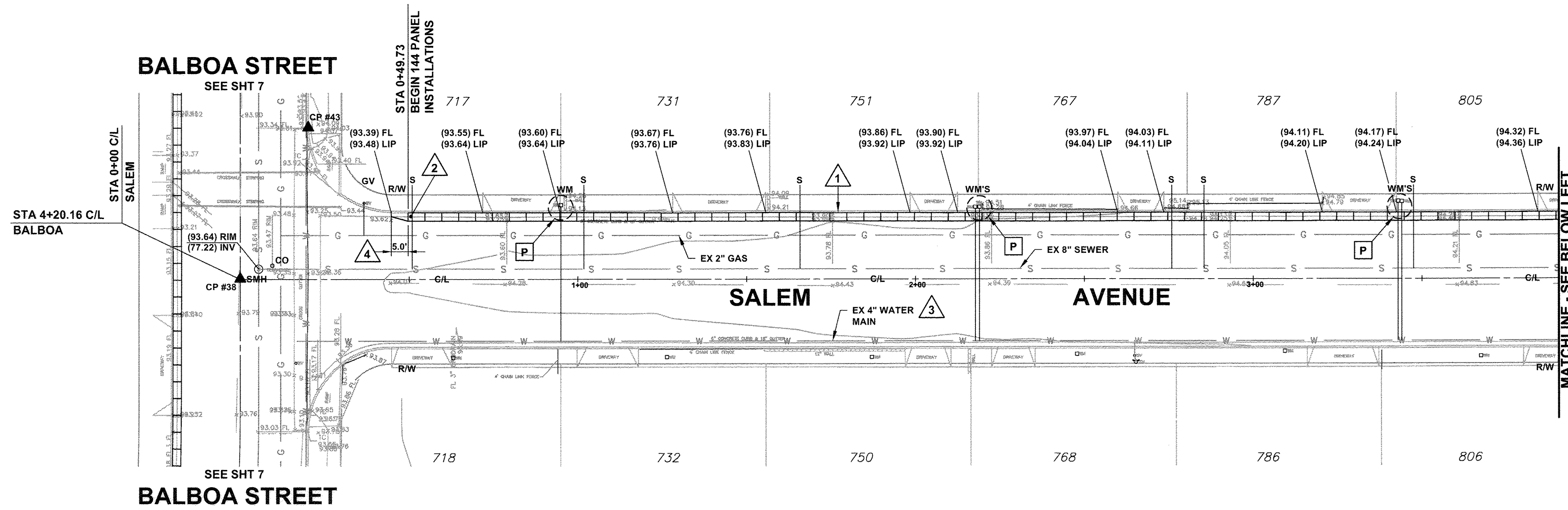

PAGE QUANTITIES

- ① = 144 PANELS
- ② = 1 OBSERVATION WELL
- P = 7
- CONCRETE TRANSITIONS = 2

NOTE: PANEL CROSS SLOPE IS 8% ON THIS SHEET

CONSTRUCTION NOTES

- ①/⑧ INSTALL PRECAST PERVIOUS CONCRETE PAVEMENT PANELS. TRANSITION BACK TO EXISTING GUTTER WIDTH LOCATED AT EACH END OF THE PANEL SECTION. SEE ①/⑧ ②/⑧
- ② INSTALL OBSERVATION WELL. SEE ①/⑧
- ③ EXISTING WATERLINE IS 8" - 18" DEEP. SERVICES ARE 2-INCH DIA GALVANIZED PIPE WITH A 1-INCH DIA POLYETHYLENE LINE INSIDE.
- ④ GUTTER TRANSITION. SEE ①/⑧

LEGEND

- ⑫ P POT HOLE REQUIRED
- 999 RESIDENTIAL ADDRESS

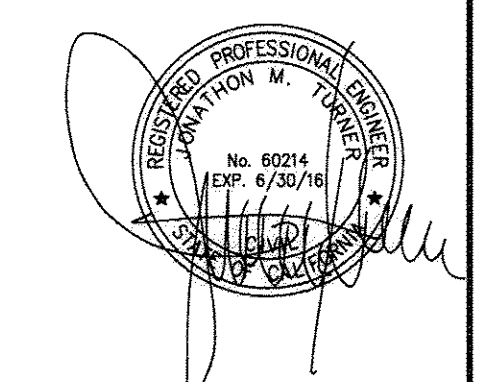
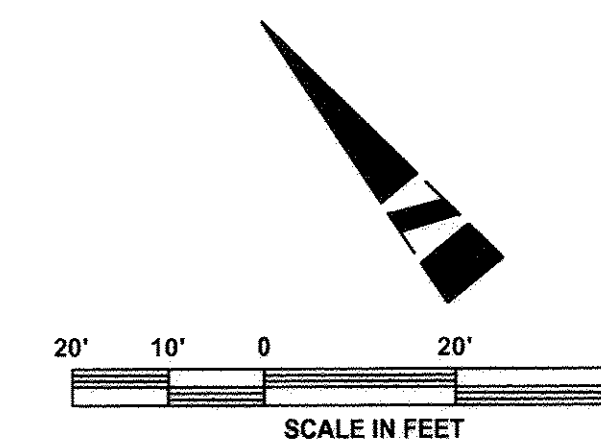
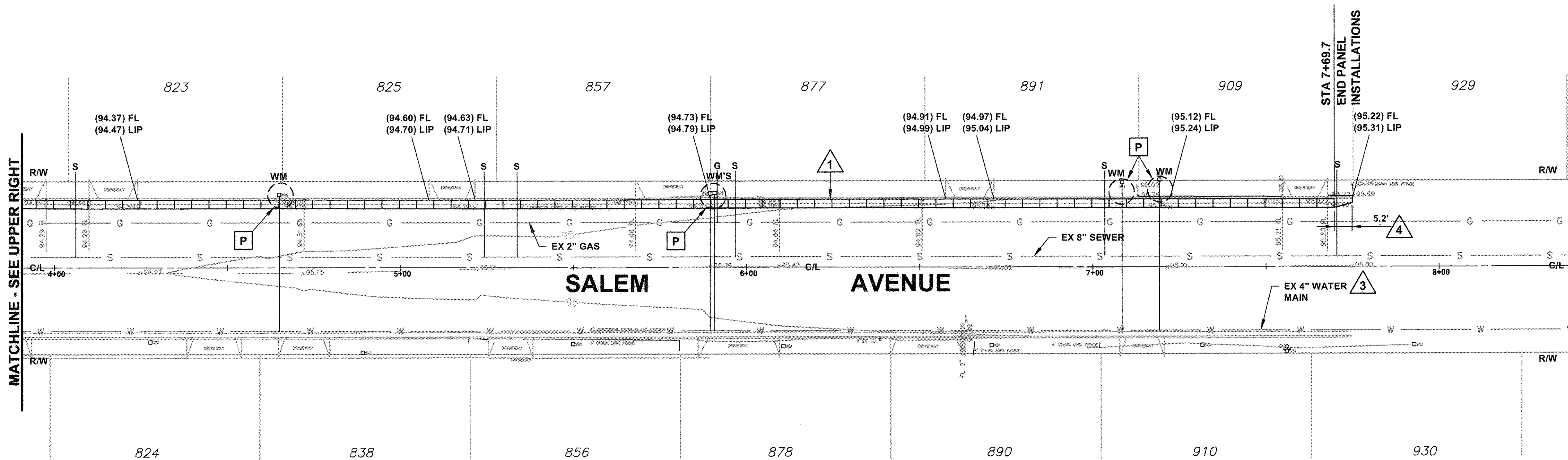

SAVE DATE: 1/12/15 FRED P:\PROJECTS\WMPD11401_EL RIO GROUNDWATER RECHARGE\CAD\PLANS\SET_SHT-05.DWG

D			
C			
B			
A	ISSUED FOR BID	1-12-15	
Δ	REVISION DESCRIPTION	APP. DATE	

PREPARED BY:
PHOENIX CIVIL ENGINEERING, INC.
 4532 TELEPHONE ROAD SUITE 113
 VENTURA, CA 93003
 (805) 658-6800

DESIGNED: JT
 DRAWN: AR
 CHECKED: GD

PROJECT MANAGER: *G. Derossett* 1/15/15
 DISTRICT DIRECTOR: *J. Turner* 1/16/2015
 DATE: 1/15/2015

**COUNTY OF VENTURA
 PUBLIC WORKS AGENCY
 WATERSHED PROTECTION DISTRICT**

SPEC. NO.
WP15-09
 PROJ. NO.
40560

**EL RIO RETROFIT FOR
 GROUNDWATER RECHARGE
 SALEM AVENUE**

SHEET **5**
 OF **8**
 DRAWING NO.
Y-2-3783

DATE PROJECT COMPLETED 3/9/2016
 REVISIONS SUBMITTED BY J. EVERETT
 DRAWING REVISED BY J. TURNER
 APPROVED BY G. DEROSSETTI DATE 5/3/16

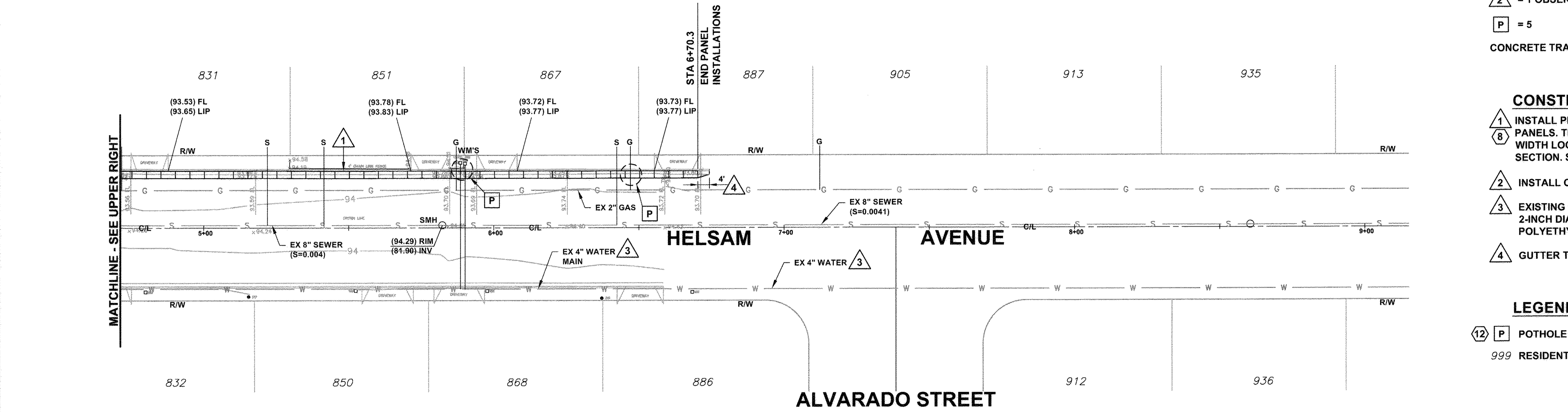
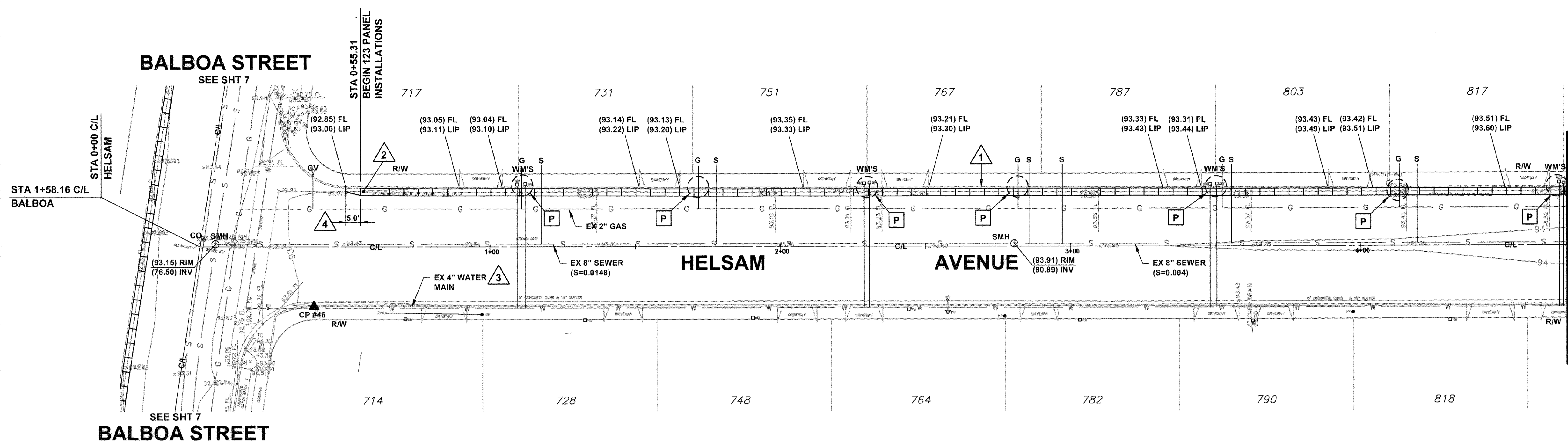

NOTE: PANEL CROSS SLOPE IS 5.5% ON THIS SHEET

PAGE QUANTITIES

- 1 = 123 PANELS
- 2 = 1 OBSERVATION WELL
- P = 5
- CONCRETE TRANSITIONS = 2

CONSTRUCTION NOTES

- 1 INSTALL PRECAST PERVIOUS CONCRETE PAVEMENT PANELS. TRANSITION BACK TO EXISTING GUTTER WIDTH LOCATED AT EACH END OF THE PANEL SECTION. SEE 1/8 2/8
- 2 INSTALL OBSERVATION WELL. SEE 1/8
- 3 EXISTING WATERLINE IS 8" - 18" DEEP. SERVICES ARE 2-INCH DIA GALVANIZED PIPE WITH A 1-INCH DIA POLYETHYLENE LINE INSIDE.
- 4 GUTTER TRANSITION. SEE 1/8

LEGEND

- 12 P POT HOLE REQUIRED
- 999 RESIDENTIAL ADDRESS

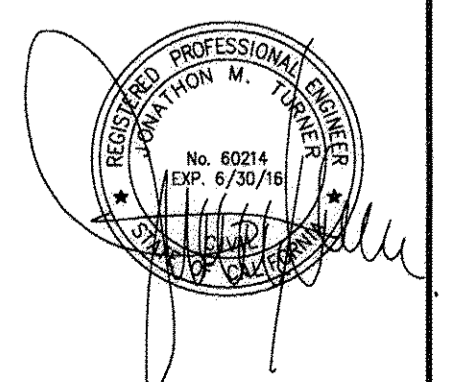
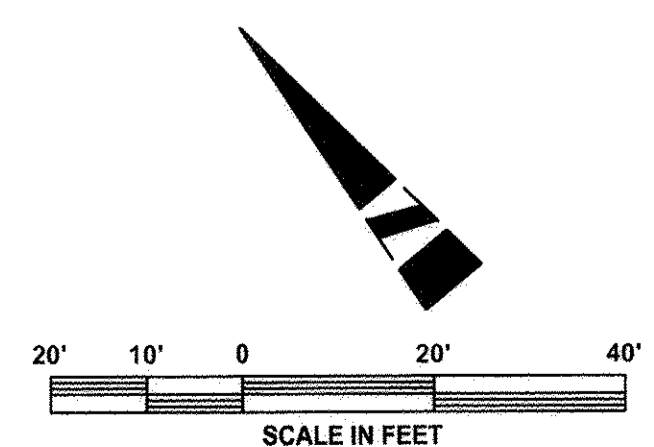

SAVE DATE: 1/2/15 FRED P:\PROJECTS\WMPD11401_EL_RIO_GROUNDWATER_RECHARGE\CAD\PLANS\T_SHT-06.DWG

D			
C			
B			
A	ISSUED FOR BID	1-12-15	
Δ	REVISION	DESCRIPTION	APP. DATE

PREPARED BY:
PHOENIX CIVIL ENGINEERING, INC.
 4532 TELEPHONE ROAD SUITE 113
 VENTURA, CA 93003
 (805) 658-6800

JT	DESIGNED	<i>[Signature]</i>	1/16/15
AR	DRAWN	<i>[Signature]</i>	1/16/2015
GD	CHECKED	<i>[Signature]</i>	1/15/2015

**COUNTY OF VENTURA
 PUBLIC WORKS AGENCY
 WATERSHED PROTECTION DISTRICT**

SPEC. NO.
WP15-09
 PROJ. NO.
40560

**EL RIO RETROFIT FOR
 GROUNDWATER RECHARGE
 HELSAM AVENUE**

SHEET **6**
 OF **8**
 DRAWING NO.
Y-2-3784

RECORD DRAWING
 DATE PROJECT COMPLETED 3/9/2016
 REVISIONS SUBMITTED BY J. EVERETT
 DRAWING REVISED BY J. TURNER
 APPROVED BY G. DEROSSETT DATE 5/3/16

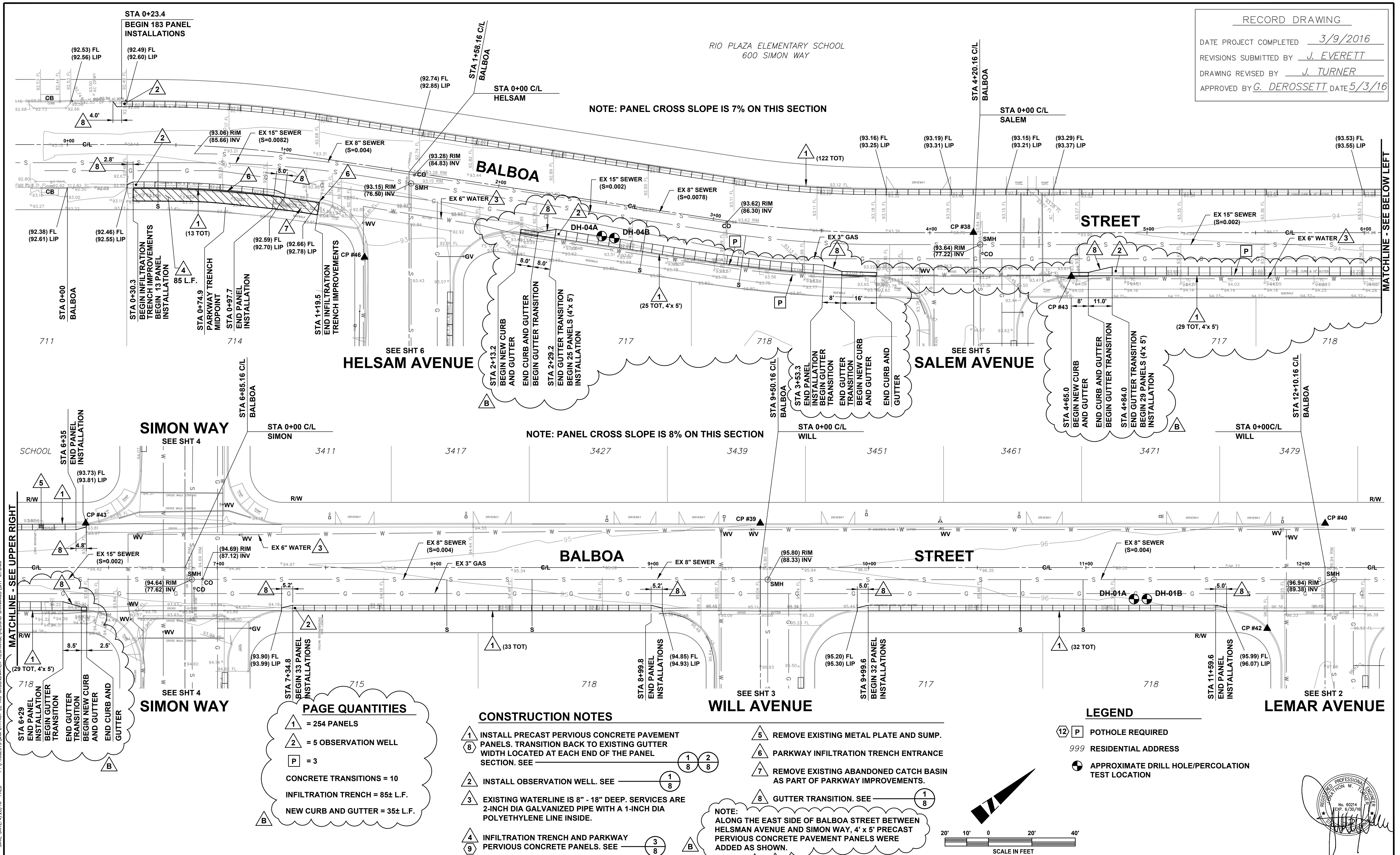

NOTE: PANEL CROSS SLOPE IS 7% ON THIS SECTION

NOTE: PANEL CROSS SLOPE IS 8% ON THIS SECTION

PAGE QUANTITIES

- 1 = 254 PANELS
- 2 = 5 OBSERVATION WELL
- P = 3

CONCRETE TRANSITIONS = 10
 INFILTRATION TRENCH = 85± L.F.
 NEW CURB AND GUTTER = 35± L.F.

CONSTRUCTION NOTES

- 1 INSTALL PRECAST PERVIOUS CONCRETE PAVEMENT PANELS. TRANSITION BACK TO EXISTING GUTTER WIDTH LOCATED AT EACH END OF THE PANEL SECTION. SEE 1 8 2
- 2 INSTALL OBSERVATION WELL. SEE 1 8
- 3 EXISTING WATERLINE IS 8" - 18" DEEP. SERVICES ARE 2-INCH DIA GALVANIZED PIPE WITH A 1-INCH DIA POLYETHYLENE LINE INSIDE.
- 4 INFILTRATION TRENCH AND PARKWAY PERVIOUS CONCRETE PANELS. SEE 3 8
- 5 REMOVE EXISTING METAL PLATE AND SUMP.
- 6 PARKWAY INFILTRATION TRENCH ENTRANCE
- 7 REMOVE EXISTING ABANDONED CATCH BASIN AS PART OF PARKWAY IMPROVEMENTS.
- 8 GUTTER TRANSITION. SEE 1 8

NOTE: ALONG THE EAST SIDE OF BALBOA STREET BETWEEN HELSAM AVENUE AND SIMON WAY, 4' x 5' PRECAST PERVIOUS CONCRETE PAVEMENT PANELS WERE ADDED AS SHOWN.

LEGEND

- 12 P POTHOLE REQUIRED
- 999 RESIDENTIAL ADDRESS
- APPROXIMATE DRILL HOLE/PERCOLATION TEST LOCATION

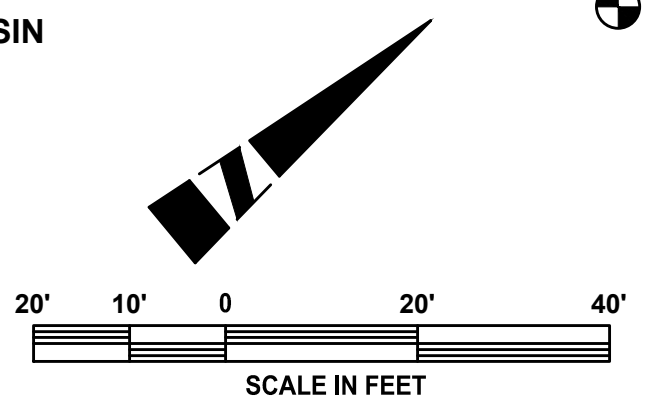

D			
B	4' PARKWAY PANELS MOVED TO STREET	4-26-16	
A	ISSUED FOR BID	1-12-15	
Δ	REVISION DESCRIPTION	APP. DATE	

PREPARED BY:
PHOENIX CIVIL ENGINEERING, INC.
 4532 TELEPHONE ROAD SUITE 113
 VENTURA, CA 93003
 (805) 658-6800

JT DESIGNED
 AR DRAWN
 GD CHECKED

PROJECT MANAGER: *[Signature]* 1/15/15
 DISTRICT DIRECTOR: *[Signature]* 1/16/2015
 DATE: 1/15/2015

**COUNTY OF VENTURA
 PUBLIC WORKS AGENCY
 WATERSHED PROTECTION DISTRICT**

SPEC. NO.
WP15-09
 PROJ. NO.
40580

**EL RIO RETROFIT FOR
 GROUNDWATER RECHARGE
 BALBOA STREET**

SHEET **7**
 OF **8**
 DRAWING NO.
Y-2-3785

P:\PROJECTS\WPRD11401_EL RIO GROUNDWATER RECHARGE\RECORD DRAWINGS\SHT-07.DWG
 SAVE DATE: 4/28/16 FRED
 PLOT DATE: 4/28/16

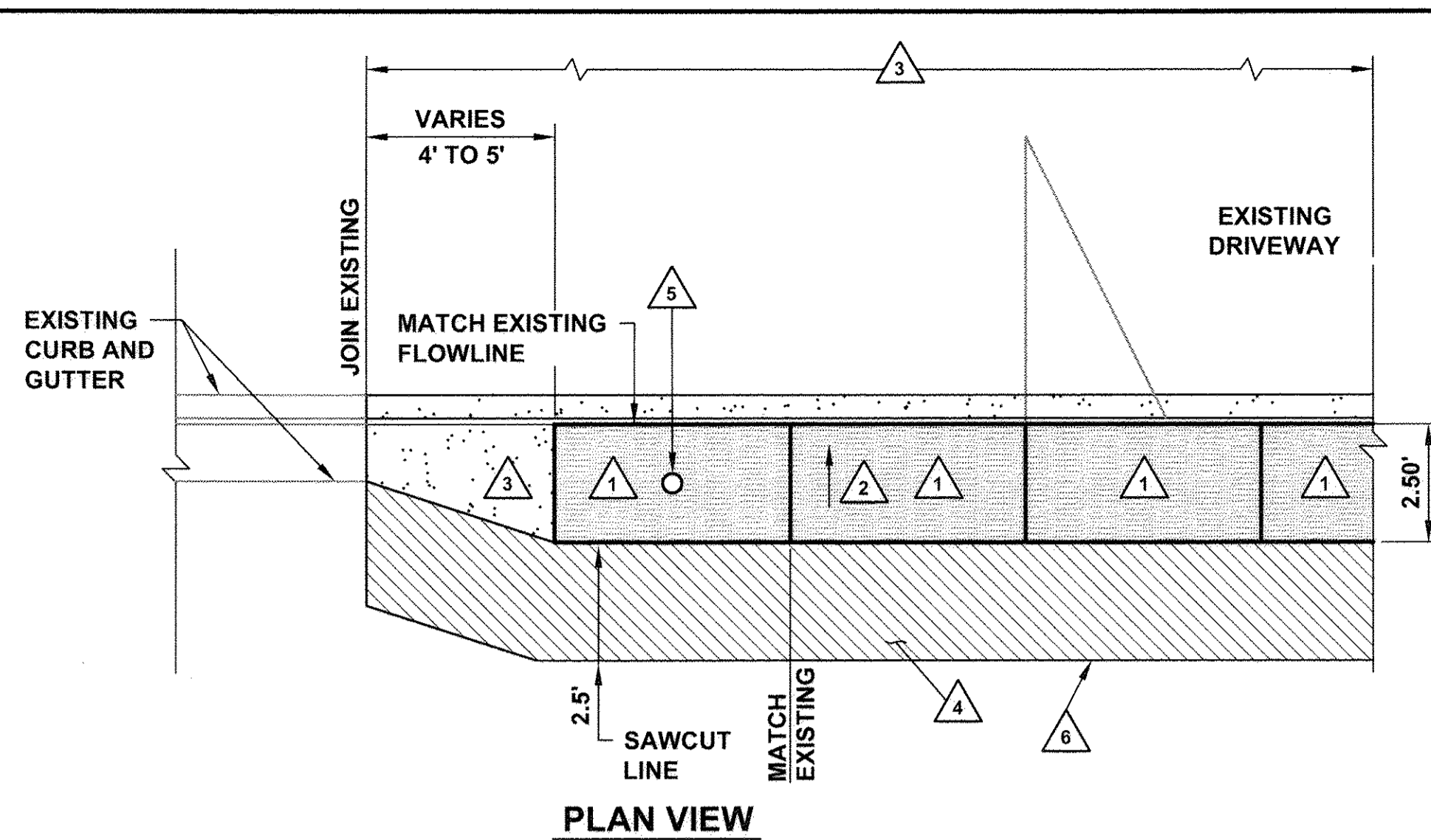

- 1 INSTALL MODULAR PRECAST PERVIOUS CONCRETE PANEL WITH LIFTING POINTS IN SURFACE AND CONCRETE CURB PER SPPWC 120-2 TYPE A1
- 2 SLOPE VARIES AS SHOWN ON PLAN SHEETS
- 3 REMOVE EXISTING CURB AND GUTTER AND REPLACE WITH NEW CONCRETE CURB AND GUTTER PER SPPWC 120-2 TYPE A2, MATCH EXISTING
- 4 SAWCUT AND REMOVE AC PAVEMENT. TACK COAT SAWCUT EDGES AND REPLACE AC PAVEMENT PER DETAILS SHOWN ON THIS SHEET
- 5 4-INCH DIAMETER PERFORATED PIPE OBSERVATION WELL (CENTERED IN PANEL). COVER PIPE EXTERIOR WITH A FILTER SOCK AND INSTALL A ZURN VANDAL PROOF SCREW LID TO A ANCHORED METAL PLATE AT THE BOTTOM OF TRENCH. SEE PLAN SHEETS FOR ACTUAL LOCATION
- 6 MATCH EXISTING ELEVATION OF AC PAVEMENT

TYPICAL GUTTER TRANSITION DETAIL

SCALE: 1" = 3'

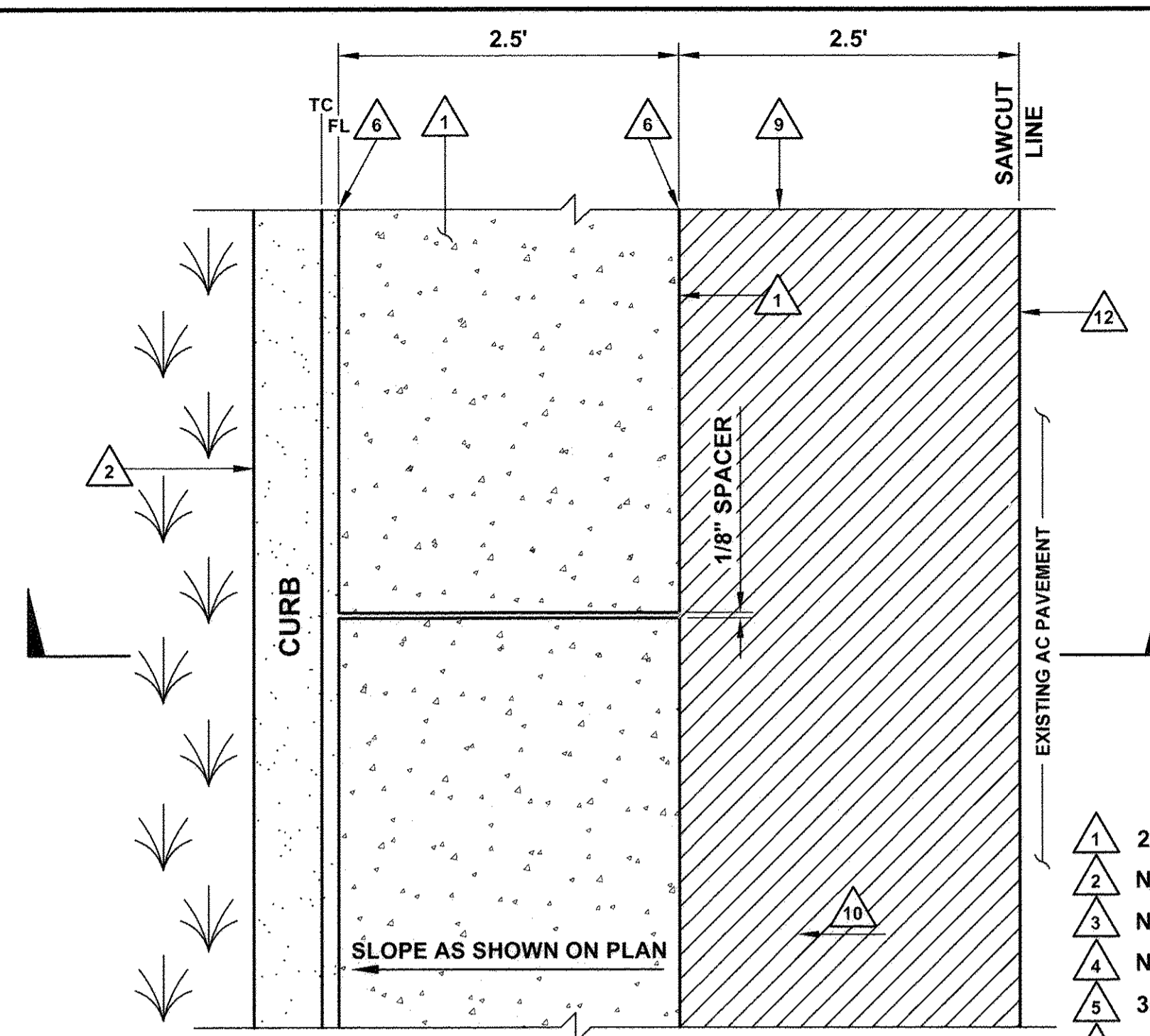
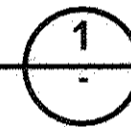

PLAN VIEW

- 1 2.5' WIDE x 5' LONG PRECAST PERVIOUS CONCRETE PANEL
- 2 NEW CONCRETE CURB PER SPPWC 120-2 TYPE A1, MATCH EXISTING
- 3 NO. 67 (3/8-INCH) WASHED CRUSHED STONE LEVELING COURSE
- 4 NO. 4 (3/4-INCH) WASHED CRUSHED STONE RESERVOIR COURSE
- 5 30 MIL PVC IMPERMEABLE LINER
- 6 1/2-INCH THICK PRE-MOLDED EXPANSION JOINT FILLER CONFORMING TO ASTM D1751
- 7 PERMANENT LIFTING POINT (TYP) (WITH PLUG)
- 8 4-INCH DIAMETER PERFORATED PIPE OBSERVATION WELL (CENTERED IN PANEL) AT LOCATIONS SHOWN ON PLANS. COVER PIPE EXTERIOR WITH A FILTER SOCK AND INSTALL A ZURN VANDAL PROOF SCREW LID TO AN ANCHORED METAL PLATE AT THE BOTTOM OF TRENCH
- 9 SAWCUT AND REMOVE AC PAVEMENT. TACK COAT SAWCUT EDGES AND REPLACE AC PAVEMENT PER DETAILS SHOWN ON THIS SHEET

PRECAST PERVIOUS CONCRETE PANEL SECTION

SCALE: 1" = 1'

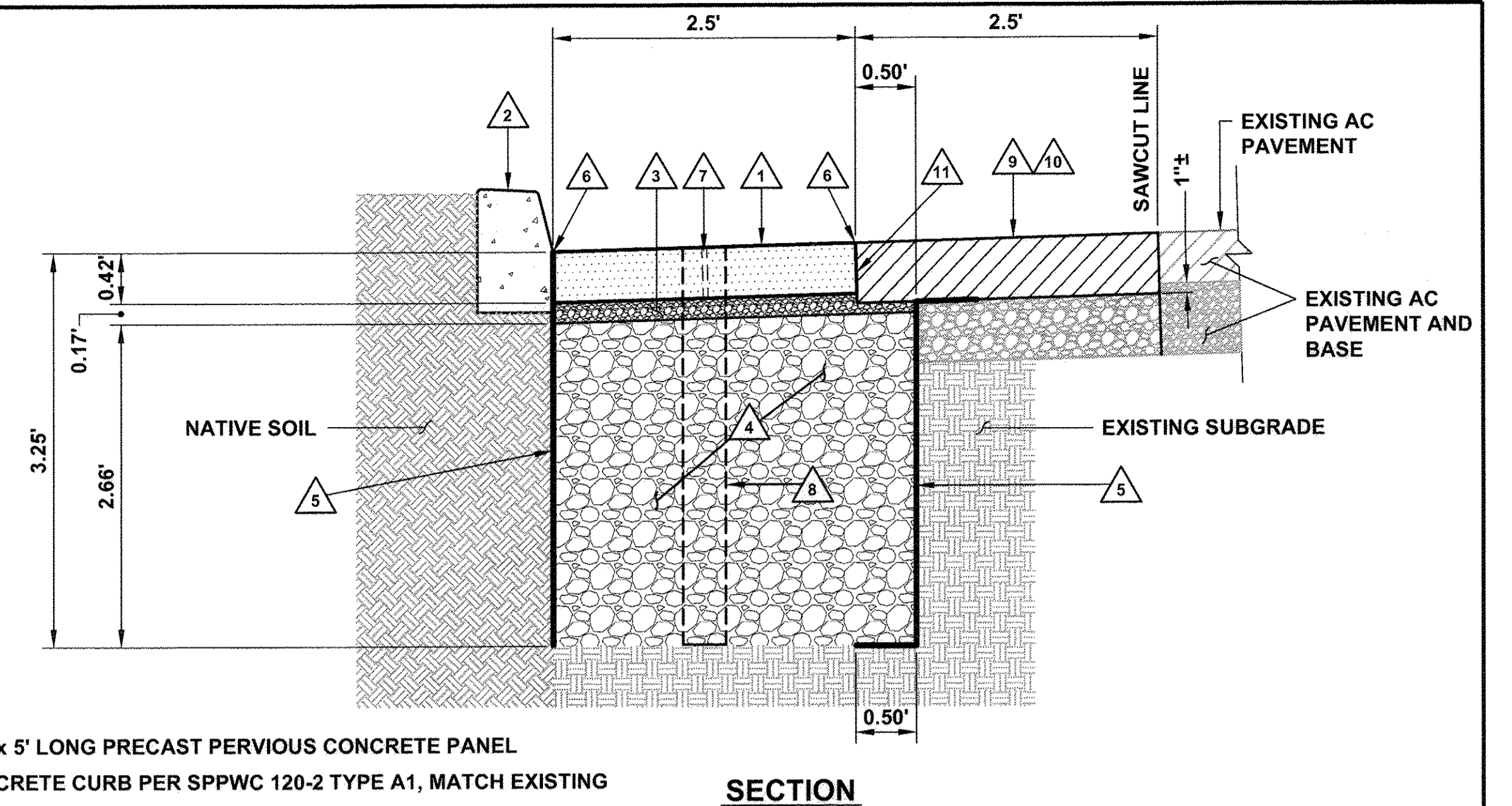
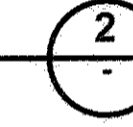

SECTION

- 10 AC SLOT PAVE SLOPE TO TRANSITION FROM EXISTING STREET MATCH LINE TO EDGE OF PRECAST PERVIOUS CONCRETE PANEL AS SHOWN ON PLAN SHEETS
- 11 TACK COAT
- 12 MATCH EXISTING ELEVATION OF AC PAVEMENT

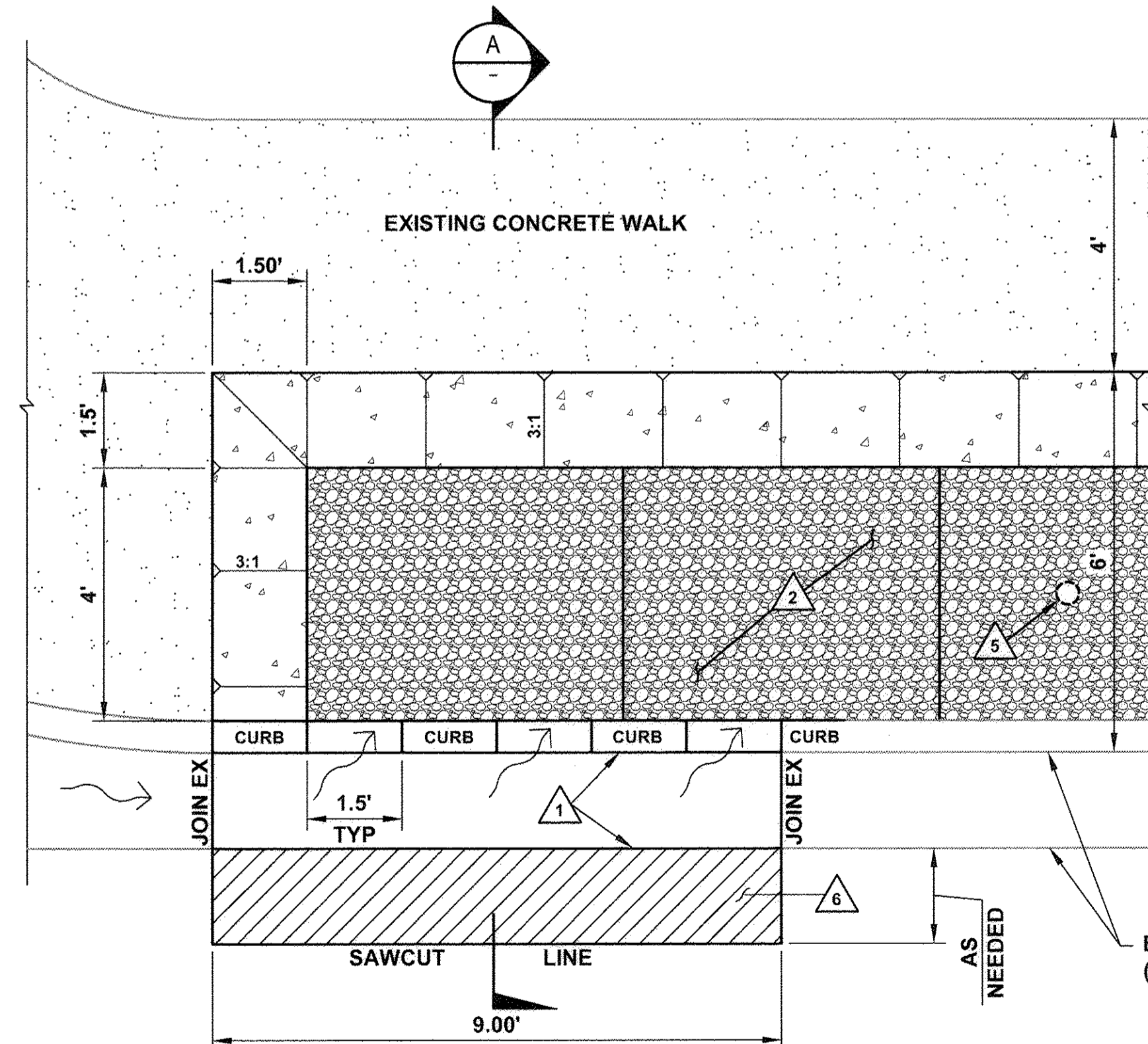

PARKWAY INFILTRATION TRENCH ENTRANCE DETAIL

SCALE: 1" = 2'

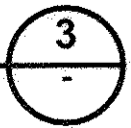

- 1 REMOVE EXISTING CURB AND GUTTER AND REPLACE WITH NEW CONCRETE CURB AND GUTTER PER SPPWC 120-2 TYPE A2, MATCH EXISTING AT TWO LOCATIONS ALONG IMPROVED PARKWAY AT UPSTREAM END AND AT MIDPOINT
- 2 4' WIDE x 5' LONG PRECAST PERVIOUS CONCRETE PANEL. PLACE AT FLOWLINE ELEVATION OF EXISTING STREET GUTTER
- 3 NO. 4 (3/4-INCH) WASHED CRUSHED STONE RESERVOIR COURSE. INFILTRATION TRENCH EXTENDS FOR LENGTH AS SHOWN ON PLAN SHEET 7 AND PER
- 4 30 MIL PVC IMPERMEABLE LINER
- 5 4-INCH DIAMETER PERFORATED PIPE OBSERVATION WELL (CENTERED IN PANEL) AT LOCATIONS SHOWN ON PLANS. COVER PIPE EXTERIOR WITH A FILTER SOCK AND INSTALL A ZURN VANDAL PROOF SCREW LID TO AN ANCHORED METAL PLATE AT THE BOTTOM OF TRENCH. SEE PLANS FOR ACTUAL LOCATIONS
- 6 SAWCUT AND REMOVE AC PAVEMENT. TACK COAT SAWCUT EDGES AND REPLACE AC PAVEMENT PER DETAILS SHOWN ON THIS SHEET
- 7 4" THICK CONCRETE BETWEEN EXISTING SIDEWALK AND PANEL
- 8 PERMANENT LIFTING POINT (TYP) (PLUG PROVIDED)
- 9 1/2-INCH THICK PRE-MOLDED EXPANSION JOINT FILLER CONFORMING TO ASTM D1751
- 10 NO. 67 (3/8-INCH) WASHED CRUSHED STONE LEVELING COURSE

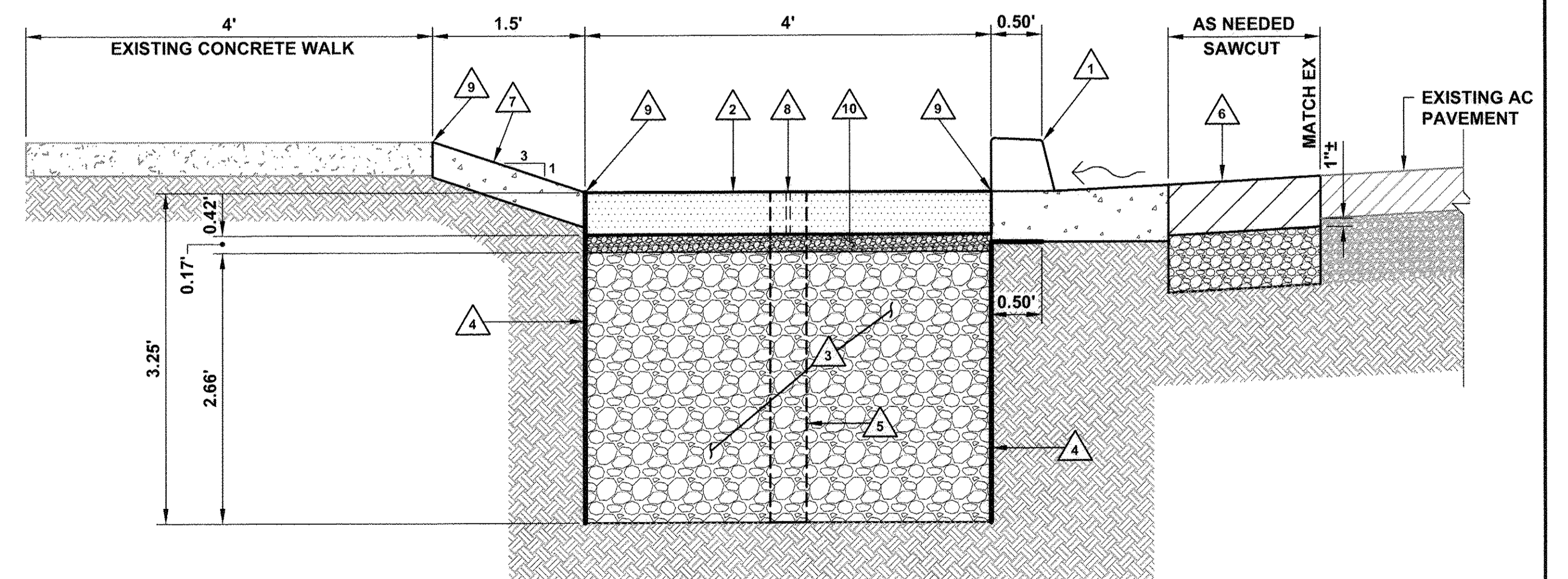

PARKWAY INFILTRATION TRENCH SECTION

SCALE: 1" = 1'

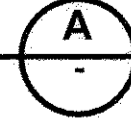

RECORD DRAWING

DATE PROJECT COMPLETED 3/9/2016
 REVISIONS SUBMITTED BY J. EVERETT
 DRAWING REVISED BY J. TURNER
 APPROVED BY G. DEROSSETT DATE 5/3/16

PLOT DATE: 1/2/15 FRED P:\PROJECTS\MWD11401_EL_RIO_GROUNDWATER_RECHARGE\CAD\PLANS\T\SHT-08.DWG

D			
C			
B			
A	ISSUED FOR BID	1-12-15	
	REVISION	DESCRIPTION	APP. DATE

PREPARED BY:
PHOENIX CIVIL ENGINEERING, INC.
 4532 TELEPHONE ROAD SUITE 113
 VENTURA, CA 93003
 (805) 658-6800

JT DESIGNED
 AR DRAWN
 GD CHECKED

DESIGNED BY: *[Signature]* DATE: 4/1/15
 DRAWN BY: *[Signature]* DATE: 1/16/2015
 CHECKED BY: *[Signature]* DATE: 1/15/2015

**COUNTY OF VENTURA
 PUBLIC WORKS AGENCY
 WATERSHED PROTECTION DISTRICT**

SPEC. NO.
WP15-09
 PROJ. NO.
40560

**EL RIO RETROFIT FOR
 GROUNDWATER RECHARGE
 DETAILS**

SHEET **8**
 OF **8**
 DRAWING NO.
Y-2-3786

